

SP Series – Part Numbering



Features

- Push-pull self latching technology
- Ultra precision
- High contact density
- High reliability / durability
- High vibration and outer force resistance

Applications

- Telecommunications
- Professional A/V
- HDTV panel system
- Vision related equipment and much more
- Optical testing equipment
- Portable wireless radio
- CCTV
- Medical equipment

Part Numbering

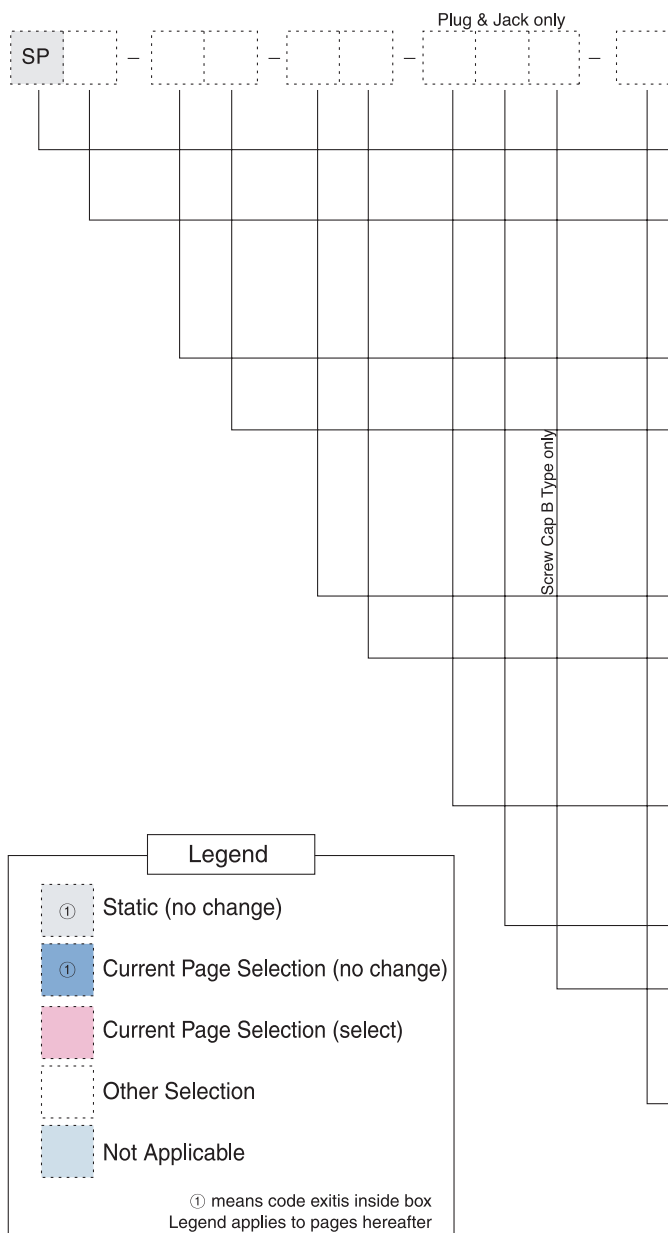

Ordering Part Number
(see examples)

Connector Series

SP - Series, multi-contact connector

Model Type

B - Mechanical keying
S - Hermaphroditic keying
C - Hermaphroditic keying(short dimension)

Size

00,0,1,2,3

Body

P - Plug PF - Fixed Plug R - Receptacle
R9 - Two nut receptacle J - Jack PT - Plug(1key Screw)
RT - Receptacle (1key Screw) PT1 - Plug (2key Screw)
RT1 - Receptacle (2key Screw)

Contact Code(Contact Arrangement and Number)

SPB - p.40 SPS - p.45 SPC - p.47

Contact Code

P = Pin S = Socket PB = PCB Pin SB = PCB Socket
LPB = Right angle PCB Pin LSB = Right angle PCB Socket
SP = Socket & Pin LSPB = Right angle PCB Socket & Pin
SPB = PCB Socket & Pin

Screw Cap Code

A - Screw Cap Terminated
B - Screw Cap + Boot needed
C - Nut Terminated

Collet Code

SPB - p.41 SPS - p.46 SPC - p.49

Boot Color Code (Screw Cap B Type only)

BK = Black WH = White RE = Red GR = Green
BU = Blue YE = Yellow BR = Brown
For detailed information see pages 41, 46, 49

Contact, Insulator Material and Cut Code

Pin		Insulator		Socket Cut		Latch Sleeve	
code 1	Material	code 2	Material	code 3	Method	code 4	Material
E	Beryllium	L	PEEK	S	Side	Y	Beryllium
A	Brass	N	PA	H	Half	R	Brass
		T	Teflon				

! none : Basic material(Pin = Beryllium, Insulator = PEEK, Cut = Side, Sleeve = Beryllium) or for custom materials choose from the above table.

For connectors with pin contacts only, choose code 1 + code 2 + Code 4

For connectors including socket contacts, choose code 1 + code 2 + code 3 + Code 4

Specifications subject to change without notice. Consult Sam Woo Electronics for the latest specifications.

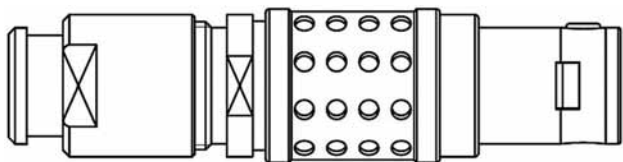

SPB Series

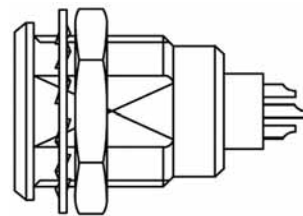

Performance

Performance	Endurance	Humidity	Temperature Range	Vibration Resistance	Shock Resistance	Corrosion Test	Mated IP Rating
Value	>5,000 cycles	95%rh 140° F	-67° F +482° F	10~2000Hz, 15g	100g, 6ms	>144h	IP50

Mini-map

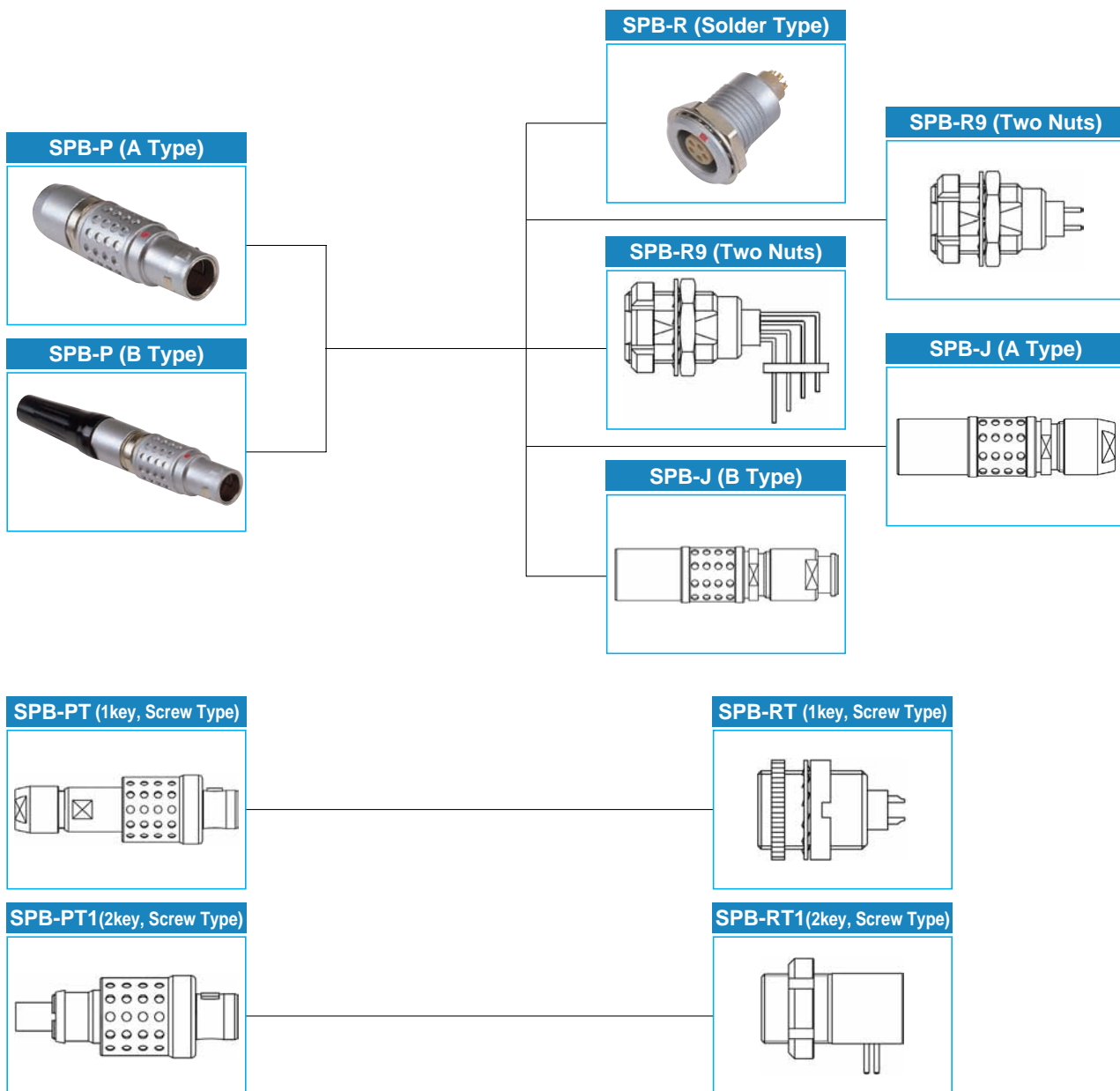

Specifications subject to change without notice. Consult Sam Woo Electronics for the latest specifications.

SP Series – B Model(Size & Shell Selection)

SPB Plug

SPB (A Type)

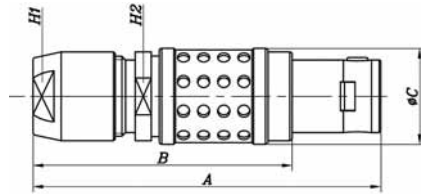

Model	A	B	C	H1	H2
SPB-00P	28.5	20.5	6.4	5.5	5.0
SPB-0P	36.0	26.0	9.5	8.0	7.0
SPB-1P	43.0	32.0	12.0	10.9	9.0
SPB-3P	58.0	43.0	18.0	15.0	14.0

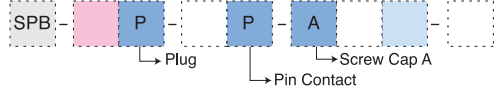

SPB (B Type)

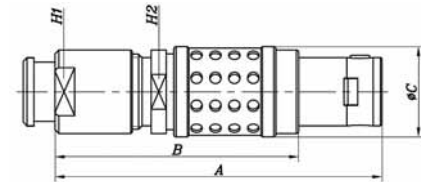

Model	A	B	C	H1	H2
SPB-0P	35.0	25.0	9.5	8.0	7.0
SPB-1P	42.0	33.0	12.0	10.0	9.0

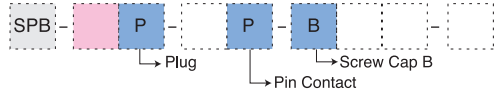

SPB Receptacle

SPB (Solder Type)

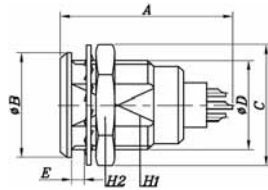

Model	A	B	C	D	E	H1	H2
SPB-00R	15.5	8.0	10.3	M7×0.5	1.0	6.3	9.0
SPB-0R	20.7	10.0	12.5	M9×0.6	1.2	7.5	11.0
SPB-1R	23.0	14.0	16.0	M12×1.0	1.5	10.5	14.0
SPB-3R	30.7	22.0	25.0	M18×1.0	2.0	16.5	22.0

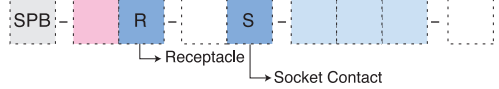

SPB (Two Nut PCB)

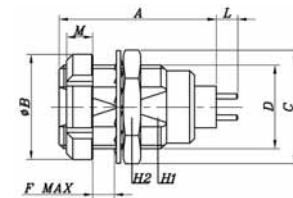
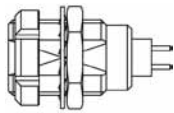

Model	A	B	C	D	E	H1	H2
SPB-0R9	16.4	12.0	12.5	M9×0.6	5.5	8.2	11.0
SPB-1R9	19.8	16.0	16.0	M12×1.0	6.0	10.5	14.0
SPB-3R9	25.8	24.0	25.0	M18×1.0	9.0	16.5	17.0

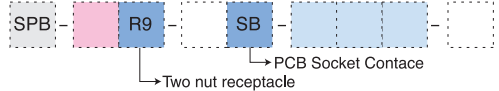

SPB (Two Nut Right-Angle-PCB)

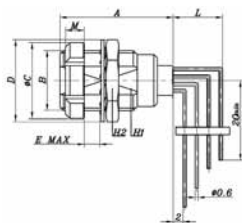
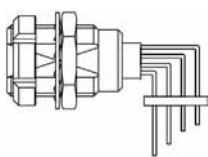

Model	A	B	C	D	E	H1	H2
SPB-0R9	18.3	12.5	12.0	M9×0.6	2.4	8.2	11.0
SPB-1R9	20.3	19.5	16.0	M12×1.0	6.0	10.5	14.0
SPB-3R9	25.8	25.0	24.0	M18×1.0	9.0	16.5	17.0



! Length (L) depends on number of contacts

SPB Jack

SPB (A Type)

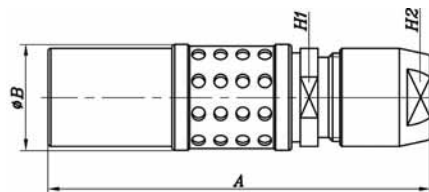
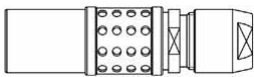

Model	A	B	H1	H2
SPB-00J	26.0	6.8	5.5	5.0
SPB-0J	35.5	9.5	8.0	7.0
SPB-1J	40.5	12.5	10.0	9.0
SPB-3J	56.0	19.0	15.0	14.0

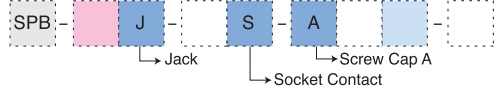

SPB (B Type)

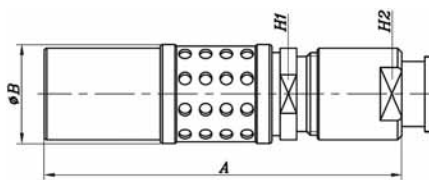
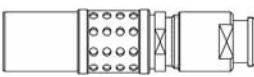

Model	A	B	H1	H2
SPB-00J	26.0	6.4	5.5	5.0
SPB-0J	34.5	9.5	8.0	7.0
SPB-1J	39.5	12.5	10.0	9.0
SPB-3J	54.5	19.0	15.0	15.0

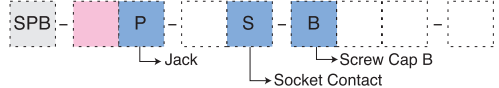

B Model (Screw Mounting) – SP Series

SPB Plug(Threaded-mounting)

SPB (Cable Collet, 1 key)

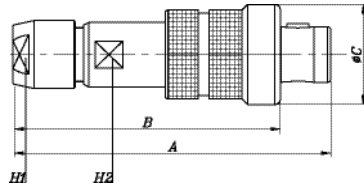
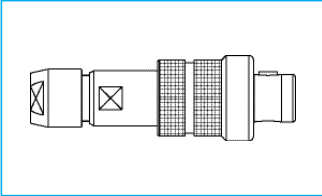

Model	A	B	C	H1	H2
SPB-00PT	28.5	24.0	9.0	5.0	5.0

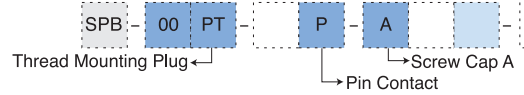

SPB (Crimp Type, 2 key)

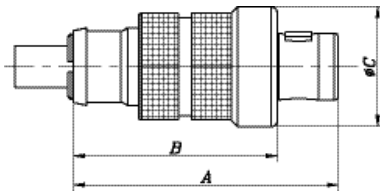
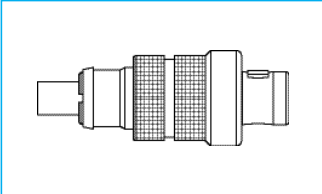

Model	A	B	C
SPB-00PT1	20.0	15.0	9.0

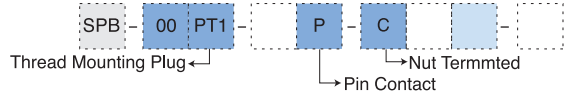

SPB-450 Antenna

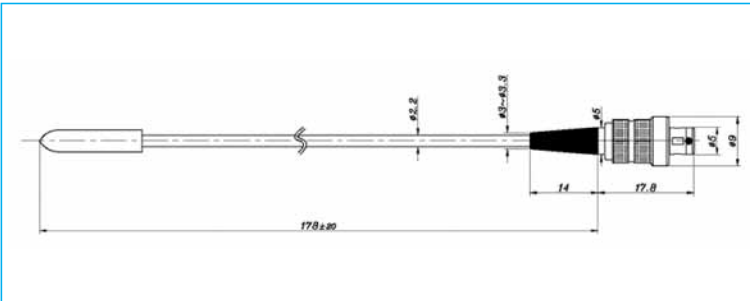

Electrical performance	Specifications
Frequency Range	450 MHz~900MHz
Connector	SPB-00PT1
Nominal Impedance	50 ohm
Radiation Pattern	Omni-Directional
Polarization	Vertical
V.S.W.R	Less than 1:2.0
Gain	0 dBi

- Cutting chart by frequency and various color of antenna cap included
 - More information on Sam Woo's Antenna catalogue P.106

SPB Receptacle (Screw-mounting)

SPB(1 Key)

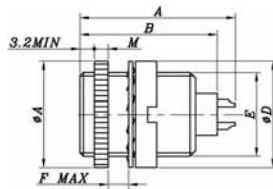
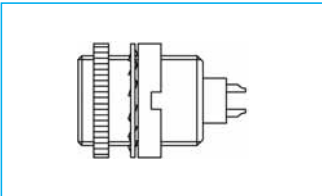

Model	A	B	C	D	E	F	M
SPB-00RT	15.5	13.7	9.5	9.0	M7×0.5	4.2	2.0

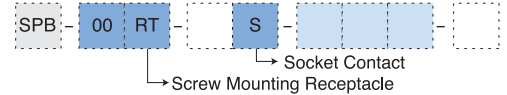

SPB(2 Key)

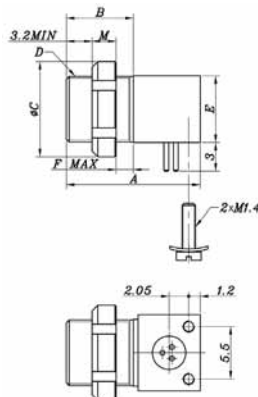
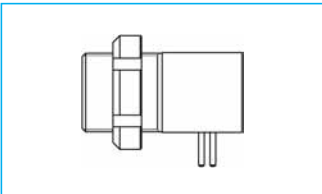

Model	A	B	C	D	E	F	M
SPB-00RT1	14.0	7.0	10.0	M7×0.5	7.0	1.8	2.5

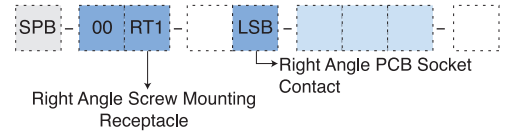

- ! PT only mates with RT.
- ! PT1 only mates with RT1.

Specifications subject to change without notice. Consult Sam Woo Electronics for the latest specifications.

SP Series – S Model Performance / Mini-map

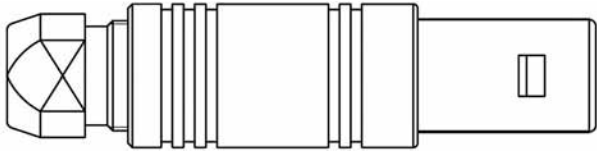

SPS Series

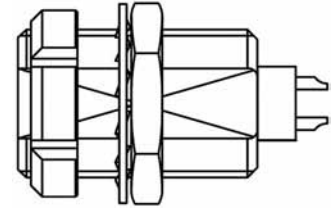

Performance

Performance	Endurance	Humidity	Temperature Range	Vibration Resistance	Shock Resistance	Corrosion Test	Mated IP Rating
Value	>5,000 cycles	95%rh 140°F	-67°F +482°F	10~2000Hz, 15g	100g, 6ms	>144h	IP50

Mini-map

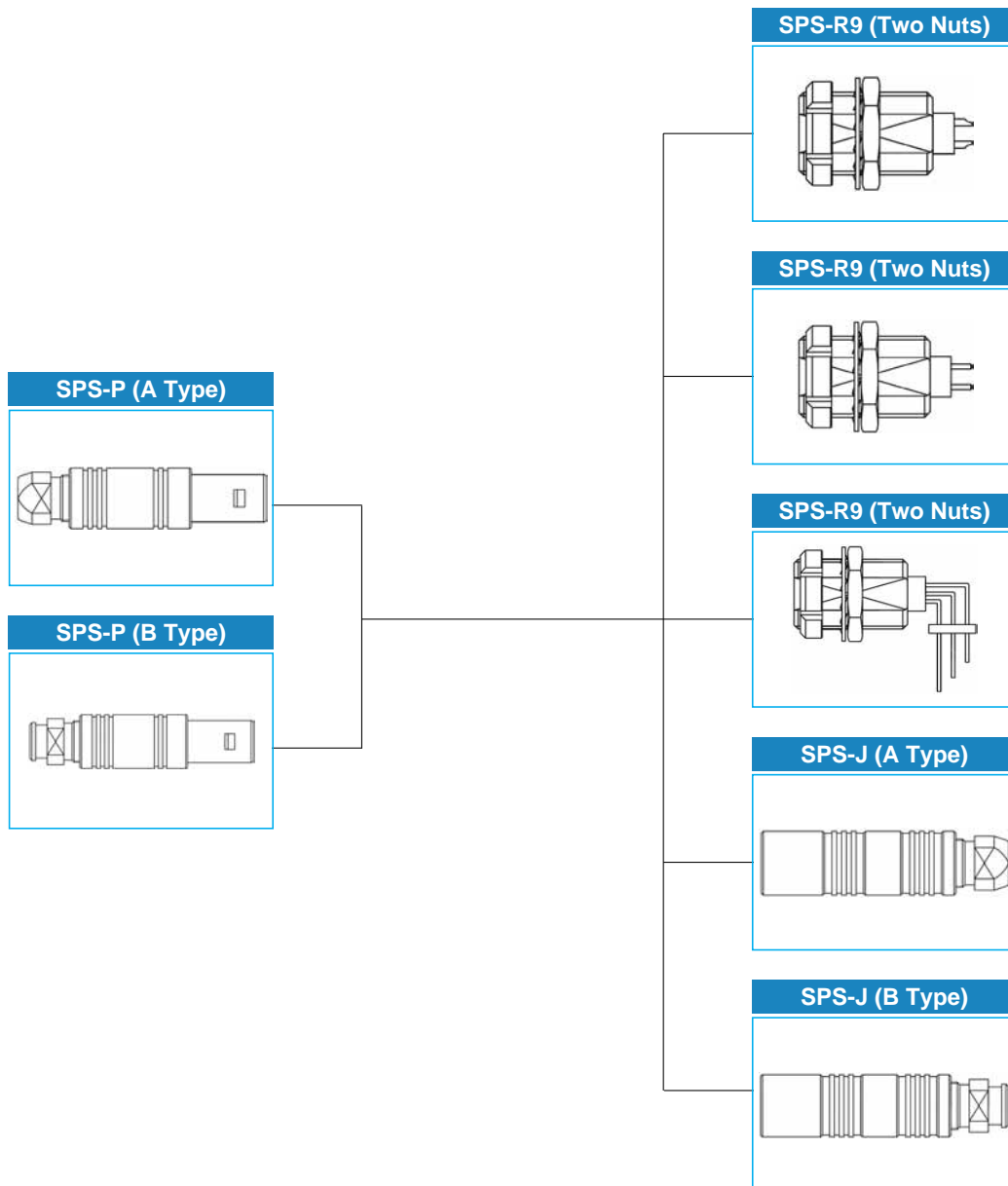

Specifications subject to change without notice. Consult Sam Woo Electronics for the latest specifications.

SPS Plug

SPS (A Type)

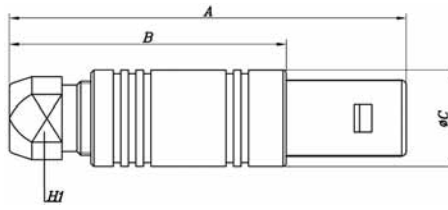
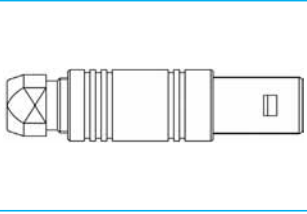

Model	A	B	C	H2
SPS-00P	26.0	18.0	6.4	4.5
SPS-0P	34.5	24.5	9.0	6.5
SPS-1P	42.5	31.5	12.0	8.5
SPS-2P	52.0	40.0	14.8	11.0
SPS-3P	61.0	46.0	17.8	14.0



SPS (B Type)

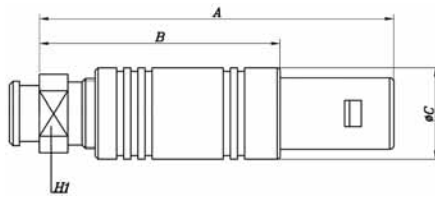
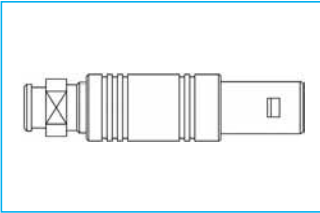

Model	A	B	C	H2
SPS-00P	26.0	18.0	6.4	6.0
SPS-0P	34.5	24.5	9.0	7.0
SPS-1P	42.5	31.5	12.0	9.0
SPS-2P	52.0	40.0	14.8	12.0
SPS-3P	61.0	46.0	17.8	14.0



SPS Receptacle

SPS (Two Nut Solder)

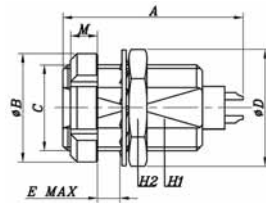
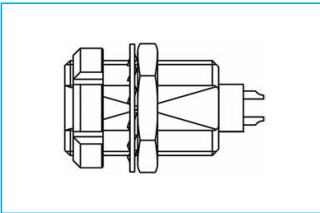

Model	A	B	C	D	E	H1	H2
SPS-0R9	17.5	12.0	M9×0.6	12.5	8.5	8.2	11.0
SPS-1R9	20.2	16.0	M12×1.0	16.0	10.0	10.5	14.0
SPS-2R9	24.5	19.5	M12×1.0	20.0	11.0	13.5	17.0
SPS-3R9	29.0	24.0	M118×1.0	25.2	14.0	16.5	22.0



SPS (Two Nut PCB)

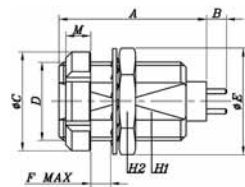
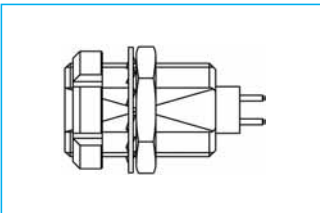

Model	A	B	C	D	E	F	H1	H2
SPS-0R9	15.0	①	12.0	M9×0.6	12.5	8.5	8.2	11.0
SPS-1R9	17.5	①	16.0	M12×1.0	16.0	10.0	10.5	14.0
SPS-2R9	20.0	①	20.0	M15×1.0	19.5	11.0	13.5	17.0
SPS-3R9	24.0	①	24.0	M18×1.0	25.2	14.0	16.5	22.0



SPS (Two Nut Right Angle PCB)

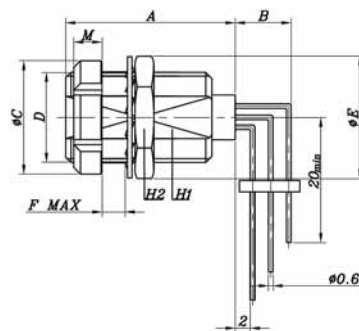
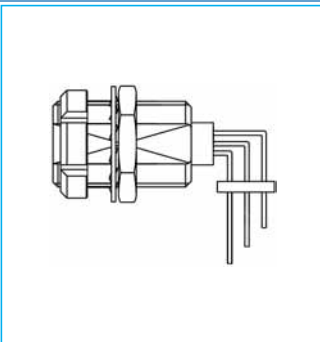

Model	A	B	C	D	E	F	H1	H2
SPS-0R9	15.0	①	12.0	M9×0.6	12.5	8.5	8.2	11.0
SPS-1R9	17.5	①	16.0	M12×1.0	16.0	10.0	10.5	14.0
SPS-2R9	20.0	①	20.0	M15×1.0	19.5	11.0	13.5	17.0
SPS-3R9	24.0	①	24.0	M18×1.0	25.2	14.0	16.5	22.0



① Length depends on number of contacts

Specifications subject to change without notice. Consult Sam Woo Electronics for the latest specifications.

SP Series – S Model

SPS Jack

SPS (A Type)

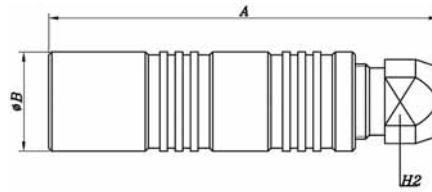
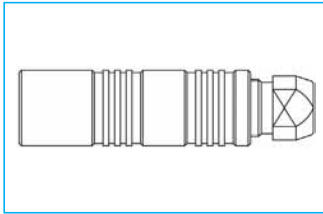

Model	A	B	H2
SPS-00J	25.0	6.5	4.5
SPS-0J	33.5	8.9	6.5
SPS-1J	40.5	11.9	8.5
SPS-2J	50.0	14.8	11.0
SPS-3J	59.0	17.8	14.0

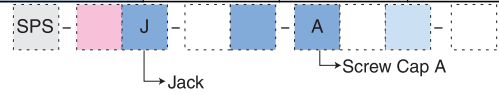

SPS (B Type)

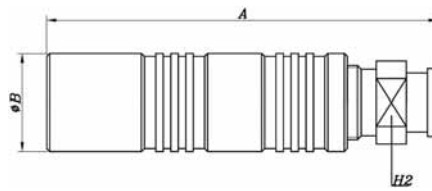
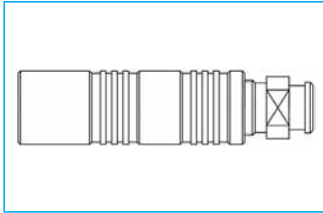

Model	A	B	H2
SPS-00J	25.0	6.5	6.0
SPS-0J	33.5	8.9	7.0
SPS-1J	40.5	11.9	9.0
SPS-2J	50.0	14.8	12.0
SPS-3J	59.0	17.8	14.0

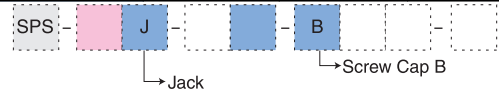

Specifications subject to change without notice. Consult Sam Woo Electronics for the latest specifications.

SP Series – S Model

Collet Code Information

Series & Model	Size	Collet Code	Collet		Cable Ø		Screw Cap Type A	Screw Cap Type B	Boot for Collet Type B			
			ØA	ØB	max	min			Dimension		Cable Ø	
									ØA	L	max	min
			SPS	00	L29	2.9				2.8	2.4	●
L31	3.1				3.0	2.6	●	●	3.5	30	3.9	3.5
0	L42	4.2			4.1	3.3	●	●	4.0	30	4.4	4.0
	L44	4.4			4.3	3.5	●	●	4.5	30	4.9	4.5
1	L62	6.2			6.1	5.3	●	●	5.4	30	6.0	5.4

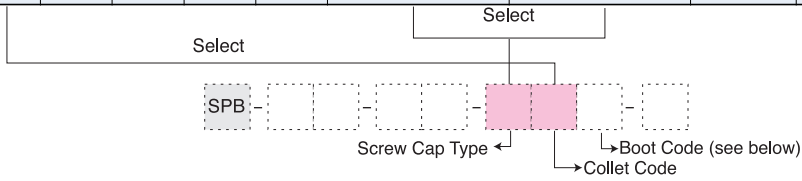

Boot Code

- BK = Black
 - WH = White
 - RD = Red
 - GN = Green
 - BU = Blue
 - YE = Yellow
 - BR = Brown
- Select color and ØA
Ex) Black boot + 4.0Ø = BK40

Material Code (For all SP series)

Pin		Insulator		Socket Cut		Latch Sleeve	
code 1	Material	code 2	Material	code 3	Method	code 4	Material
E	Beryllium	L	PEEK	S	Side	Y	Beryllium
A	Brass	N	PA	H	Half	R	Brass
		T	Teflon				

Pin cutting (Side cut)

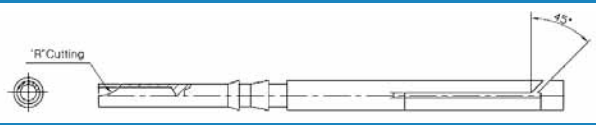

Pin cutting (Half cut)

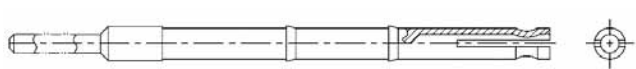

Specifications subject to change without notice. Consult Sam Woo Electronics for the latest specifications.

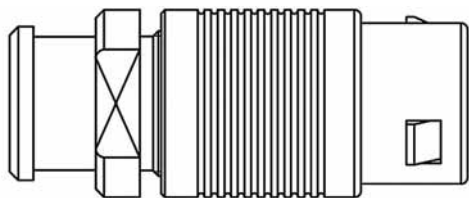

SPC Series

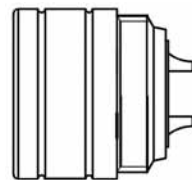

Performance

Performance	Endurance	Humidity	Temperature Range	Corrosion Test	Mated IP Rating
Value	>5,000 cycles	95%rh 140°F	-67°F +482°F	>144h	IP50

Mini-map

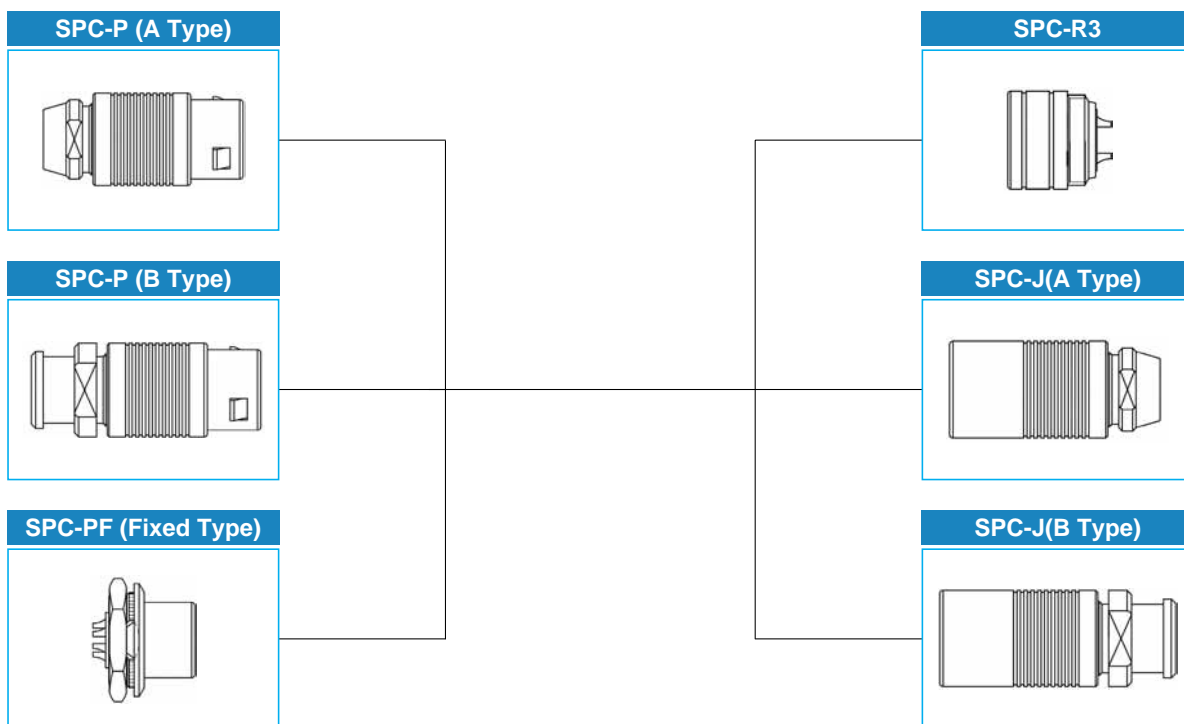

Contact Code

Series & Model	Size	Contact Code	Current	Contact Ø	No. of Contact	Contact Arrangement
SPC	2	306	12A	1.3	6	

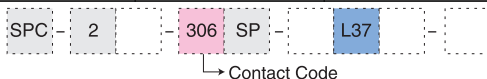

Specifications subject to change without notice. Consult Sam Woo Electronics for the latest specifications.

SP Series – C Model

SPC Plug

SPC (A Type)

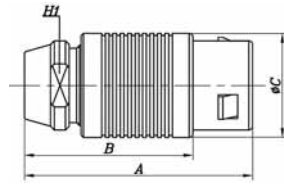
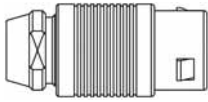

Model	A	B	ØC	H1
SPC-2P	30	22	14	10.5

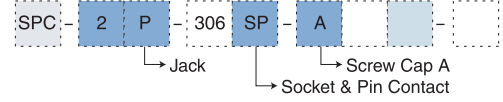

SPC (B Type)

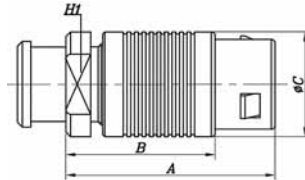
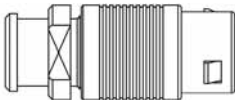

Model	A	B	ØC	H1
SPC-2P	28.4	20.4	14.	12

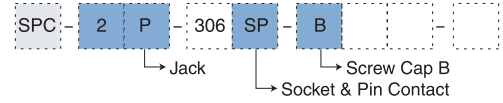

SPC (Fixed Type)

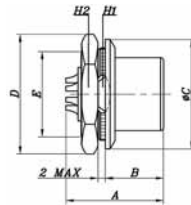
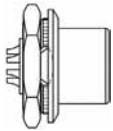

Model	A	B	ØC	ØD	E	H1	H2
SPC-2PF	17	9.5	18	19.5	M15×1	13.8	17

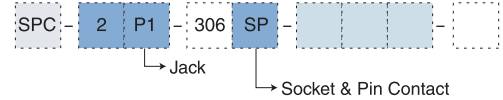

SPC Receptacle

SPC (Type 3)

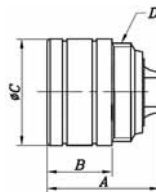
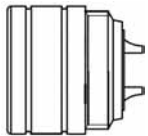

Model	A	B	ØC	D
SPC-2R3	15.6	8.5	14	M13×0.75

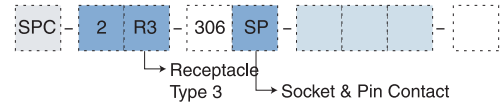

SPC Jack

SPC (A Type)

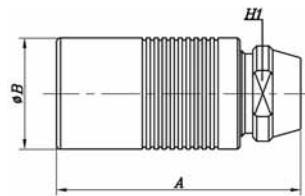
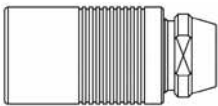

Model	A	B	H1
SPC-2J	28	14	10.5

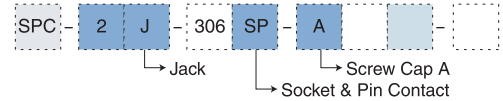

SPC (B Type)

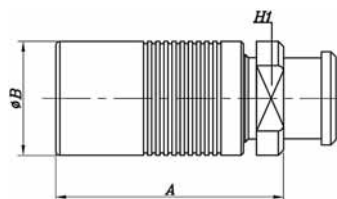
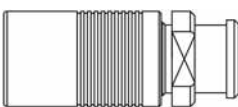

Model	A	B	H1
SPC-2J	26.4	14	12

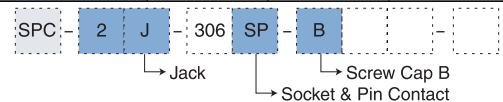

Specifications subject to change without notice. Consult Sam Woo Electronics for the latest specifications.

Collet Code Information

Series & Model	Size	Collet Code												
			Collet		Cable Ø		Screw Cap Type A	Screw Cap Type B	Boot for Collet Type B		Dimension		Cable Ø	
			ØA	ØB	max	min			ØA	L	max	min		
SPC	2	L37	3.7		3.6	3.2	●	●	5.0	36	5.5	5.0		
									6.0	36	6.5	6.0		

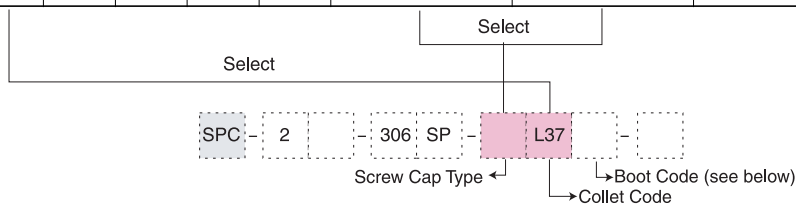

Boot Code

BK = Black		BU = Blue	
WH = White		YE = Yellow	
RD = Red		BR = Brown	
GN = Green		Select color and ØA	
Ex) Black boot + 4.0Ø = BK40			

Material Code (For all SP series)

Pin		Insulator		Socket Cut		Latch Sleeve	
code 1	Material	code 2	Material	code 3	Method	code 4	Material
E	Beryllium	L	PEEK	S	Side	Y	Beryllium
A	Brass	N	PA	H	Half	R	Brass
		T	Teflon				

Pin cutting (Side cut)



Pin cutting (Half cut)

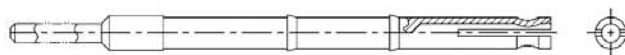

Specifications subject to change without notice. Consult Sam Woo Electronics for the latest specifications.