

SB Series – Triaxial



Features

- High performance
- Rigorous design

Applications

- Professional TV Camera
- Broadcasting Industry

SB Part Numbering



Connector Series

SB Series

Model Number

- 101 : European Standard (Self-locking System)
- 102 : American Standard (Self-locking System)
- 770 : American Standard (Quad-locking System)

Body Type

- P : Plug
- PFC : Plug Fixed with Clamping Device
- PFC1 : Plug Fixed with Short Clamping Device
- J : Jack
- RC : Receptacle with Clamping Device
- RC1 : Receptacle with Short Clamping Device
- APJF : Adapter (Plug - Jack) Flange

Accessory Code

- 101 Model
- 1.0 / 4.5 / 8.7
- 1.0 / 4.5 / 9.4
- 1.4 / 4.5 / 9.4
- 1.4 / 6.6 / 11.3
- 1.4 / 6.6 (for short clamping device)
- 102 Model
- 0.81 / 3.7 / 9.5
- 770 Model
- 0.81 / 3.7 / 9.2
- 1.63 / 7.9 / 13.2

Examples

SB - 101 P - 1.0/4.5/8.7

SB series - 101 Model Plug 1.0/4.5/8.7

SB - 101 P - 1.4/6/6/11.3A

SB series - 101 Model Plug - 1.4/6.6/11.3 Accessory only

SB - 101 PFC - 1.0/4.5/9.4

SB series - 101 Model Plug Fixed with Clamping device 1.0/4.5/9.4

SB - 101 APJF

SB series - 101 Model Adapter (Plug - Jack) Square Flange

SB - 102 J - 0.81/3.7/9.5

SB series - 102 Model Jack 0.81/3.7/9.5

SB - 102 P - 0.81/3.7/9.5 A

SB series - 102 Model Plug 0.81/3.7/9.5

SB - 770 P - 1.63/7.9/13.2

SB series - 770 Model Plug 1.63/7.9/13.2

SB - 770 J - 1.63/7.9/13.2 A

SB series - 770 Model Jack 1.63/7.9/13.2 Accessory only

Accessory Only (applies only to 102 and 770 models)

A : To order accessory only include 'A' at the end

SB Part Numbering

Accessories

Option

Specifications subject to change without notice. Consult Sam Woo Electronics for the latest specifications.

Major Performances

| Specification | 101 Model | 102 Model | 770Model |
|-----------------------|------------------|----------------|----------------|
| Impedance | 75Ω | 75Ω | 75Ω |
| VSWR | <1.2 upto 1.5GHz | <1.2 upto 1GHz | <1.2 upto 1GHz |
| Contact Resistance | <3mΩ | <3mΩ | <1mΩ |
| Operating Temperature | -20℃~+70℃ | -20℃~+70℃ | -20℃~+70℃ |

Material Used / Finish

| Material | 101 Model | 102 Model | 770Model |
|-----------------|-----------------------------|-----------------------------|---------------------------------|
| Body | Brass (Nickel & Chrome III) | Brass (Nickel & Chrome III) | Brass (Nickel & Chrome III) |
| Contacts | Brass (Gold Plate) | Brass (Gold Plate) | Brass (Gold Plate) |
| Insulator | Ptfe | Ptfe | Ptfe |
| Latching Sleeve | Brass (Nickel Plate) | Brass (Nickel Plate) | Beryllium copper (Nickel Plate) |
| Seal | Silicon Rubber | Silicon Rubber | Silicon Rubber |

SB Series Mini-map

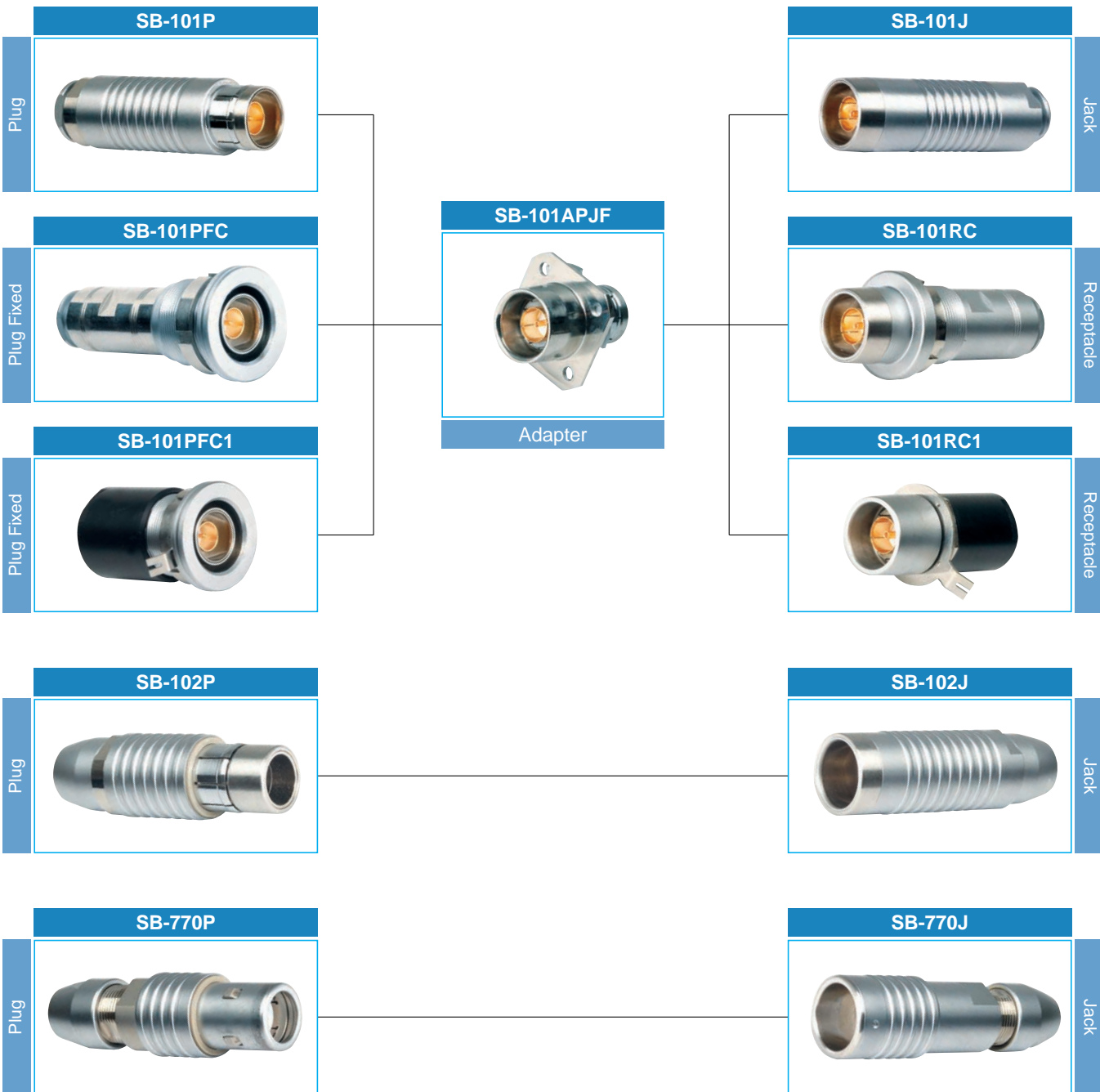

Specifications subject to change without notice. Consult Sam Woo Electronics for the latest specifications.

SB Series – Triaxial

SB-101 Model

SB-101P

Plug

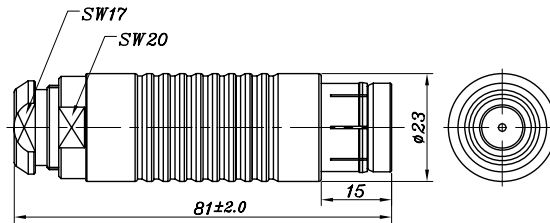

Available Accessories

- 1.0/4.5/8.7
- 1.0/4.5/9.4
- 1.4/4.5/9.4
- 1.4/6.6/11.3

SB-101PFC

Plug Fixed

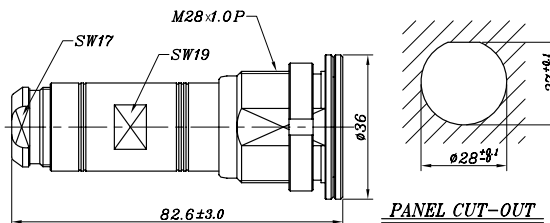

Available Accessories

- 1.0/4.5/8.7
- 1.0/4.5/9.4
- 1.4/4.5/9.4
- 1.4/6.6/11.3

SB-101PFC1

Plug Fixed

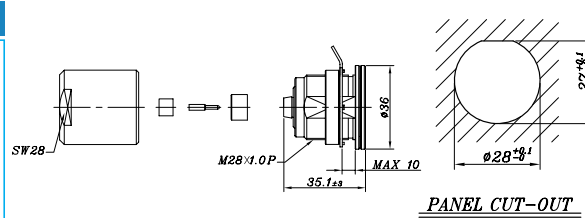

Available Accessories

- 1.4/6.6

Available Accessories

- 1.0/4.5/8.7
- 1.0/4.5/9.4
- 1.4/4.5/9.4
- 1.4/6.6/11.3

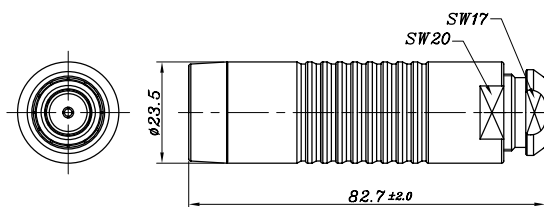

SB-101J



Jack

Available Accessories

- 1.0/4.5/8.7
- 1.0/4.5/9.4
- 1.4/4.5/9.4
- 1.4/6.6/11.3

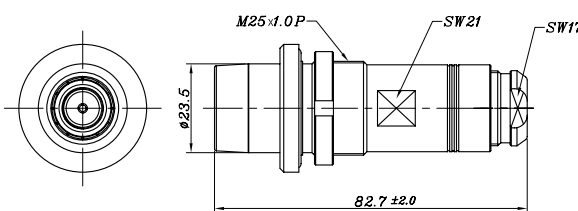

SB-101RC



Receptacle

Available Accessories

- 1.4/6.6

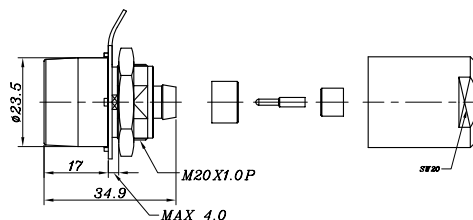

SB-101RC1



Receptacle

SB-101APJF

Adapter

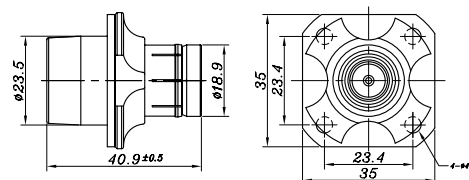

Plug - Jack Adapter

Specifications subject to change without notice. Consult Sam Woo Electronics for the latest specifications.

SB-102 Model

SB-102P

Plug

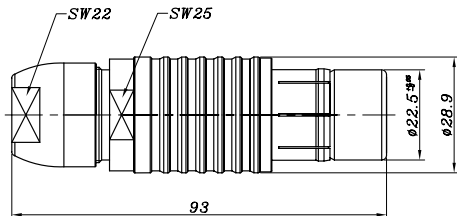

Available Accessories

- 0.81/3.7/9.5

more coming soon

Available Accessories

- 0.81/3.7/9.5

more coming soon

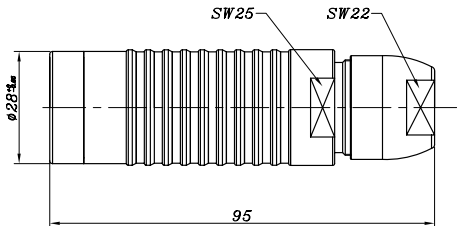

SB-102J

Jack



SB-770 Model

SB-770P

Plug

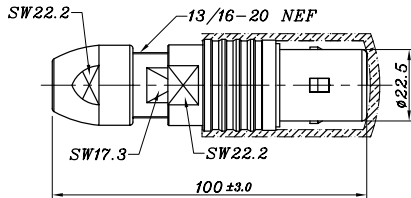

Available Accessories

- 0.81/3.7/9.2
- 1.63/7.9/13.2

more coming soon

Available Accessories

- 0.81/3.7/9.2
- 1.63/7.9/13.2

more coming soon

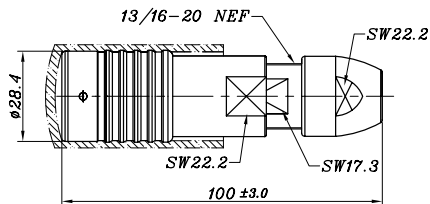

SB-770J

Jack



Specifications subject to change without notice. Consult Sam Woo Electronics for the latest specifications.

SB Series(accessories) – Triaxial

SB-101 Accessory

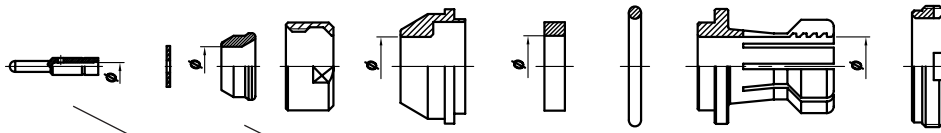

| Part Number | Diameter Ø | | | | |
|---------------------------|------------|-----|------|------|------|
| | 1 | 2 | 3 | 4 | 5 |
| SB-101P-1.0/4.5/8.7A | 1.15 | 5.8 | 8.7 | 8.8 | 8.7 |
| SB-101P-1.0 / 4.5 / 9.4A | 1.15 | 5.8 | 9.4 | 9.4 | 9.4 |
| SB-101P-1.4 / 4.5 / 9.4A | 1.5 | 5.8 | 9.4 | 9.4 | 9.4 |
| SB-101P-1.4 / 6.6 / 11.3A | 1.5 | 7.5 | 11.3 | 10.3 | 11.3 |

SB-102 Accessory

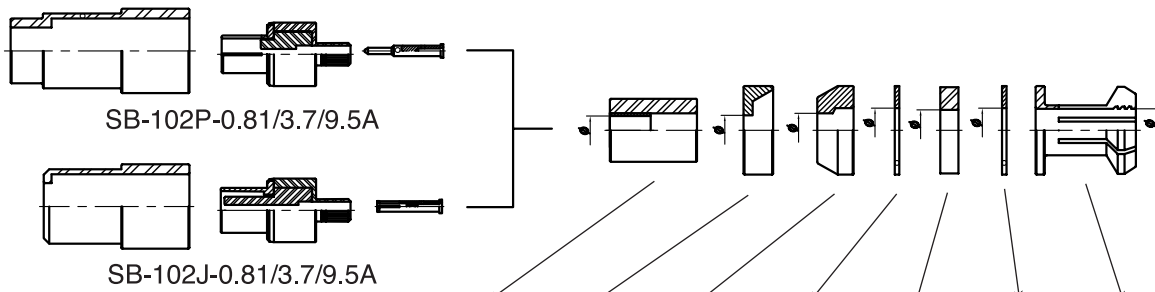

| Part Number | 1 | 2 | 3 | 4 | 5 | 6 | 7 |
|-------------|--|------|------|------|------|------|------|
| | SB-102P-0.81/3.7/9.5A SB-102J-0.81/3.7/9.5A | Ø6.3 | Ø6.6 | Ø7.5 | Ø9.8 | Ø9.0 | Ø9.8 |

SB-770 Accessory

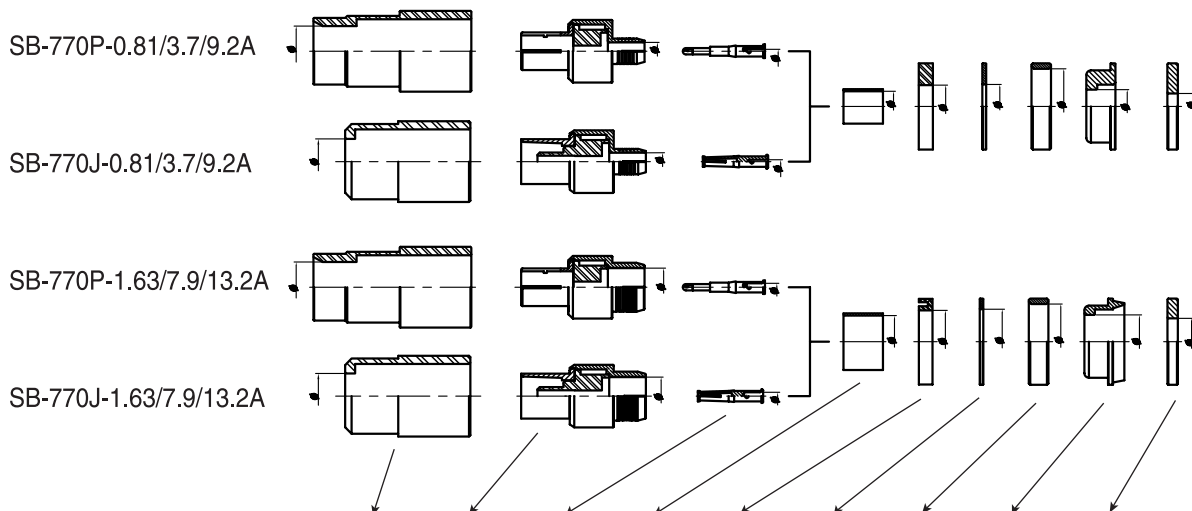

| Part Number | 1 | 2 | 3 | 4 | 5 | 6 | 7 | 8 | 9 |
|--|--|-------|------|-------|------|------|------|--------|------|
| | SB-770P-0.81/3.7/9.2A SB-770J-0.81/3.7/9.2A | Ø11.1 | Ø3.9 | Ø0.85 | Ø6.7 | Ø9.4 | Ø9.7 | Ø16.65 | Ø7.4 |
| SB-770P-1.63/7.9/13.2A SB-770J-1.63/7.9/13.2A | Ø11.1 | Ø8.4 | Ø1.7 | Ø11.5 | | | | | |

Specifications subject to change without notice. Consult Sam Woo Electronics for the latest specifications.